

These drawings and specifications are the property of H2W Technologies, Inc. They are issued in confidence and shall not be reproduced, copied, or used without written permission from H2W Technologies, Inc. (www.h2wtech.com)

REVISION TABLE					
REV	ECN#	DESCRIPTION	REV BY	APPROVED	DATE
---	---	Original Drawing	OOG	MPW	3-10-15

MOTOR HAS BEEN HIDDEN TO SHOW MOUNTING HOLES

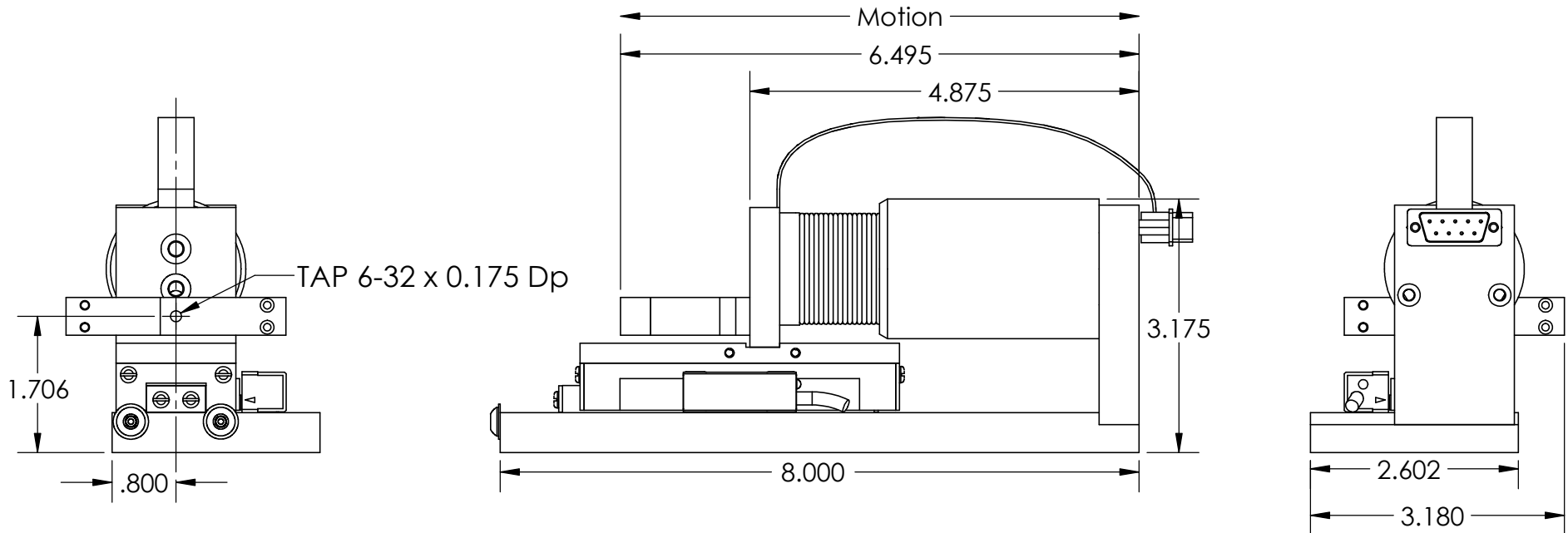
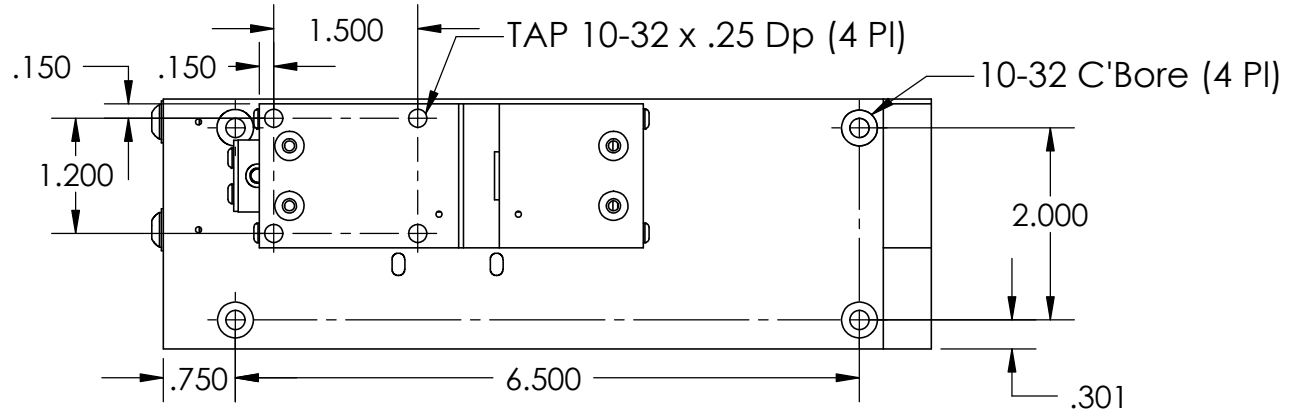

MOTOR SHOWN AT MID-STROKE



H2W Technologies, Inc.
26380 Ferry Court Santa Clarita, CA 91350 USA
Tel: (661) 291-1620 Fax: (661) 291-1626
www.h2wtech.com

UNLESS SPECIFIED OTHERWISE: All dimensions are in inches Standard Tolerances are as follows .XXX ±.005 ANGLES ±1° .XX ±.010 FILLETS .010 .X ±.020 CORNERS .010 Remove All Burs and Sharp Edges				MATERIAL		FINISH		TITLE	
								Voice Coil Positioning Stage Model #:VCS20-020-CR-01-MC-F3K	
DRAWN	DATE	APPROVED	DATE	DWG #	REV	SHEET			
OOG	2-12-16	MPW	2-12-16	31-0746	---	1 of 2			

VOICE COIL POSITIONING STAGE SPECIFICATIONS		
Motor P/N	NCC20-18-020-1A	
Stroke	2.00"	50.8 mm
Encoder Resolution	1 micron	
Encoder Type	Magnetic	
Force Transducer Resolution	3000 grams	
Bearing Type	Crossed Roller	
Moving Part	Coil Assembly	
Moving Mass	0.80 lbs	0.36 kg
Total Mass	3.60 lbs	1.63 kg
Resistance @ 20C	3.50 ohms	
Inductance @ 20C	3.70 mH	
Electrical Time Constant	1.05 msec	
Motor Constant	0.75 LBS/SQRT(Watt)	3.34 N/SQRT(Watt)
Force Constant	1.4 lbs/Amp	6.1 N/Amp
Back EMF	0.2 V/ips	6.1 V/m/sec
Force @ 100% Duty	2.0 lbs	8.9 N
Power @ 100% Duty	7 watts	
Current @ 100% Duty	1.4 Amps	
Force @ 10% Duty	6.0 lbs	26.7 N
Power @ 10% Duty	64 watts	
Current @ 10% Duty	4.3 Amps	

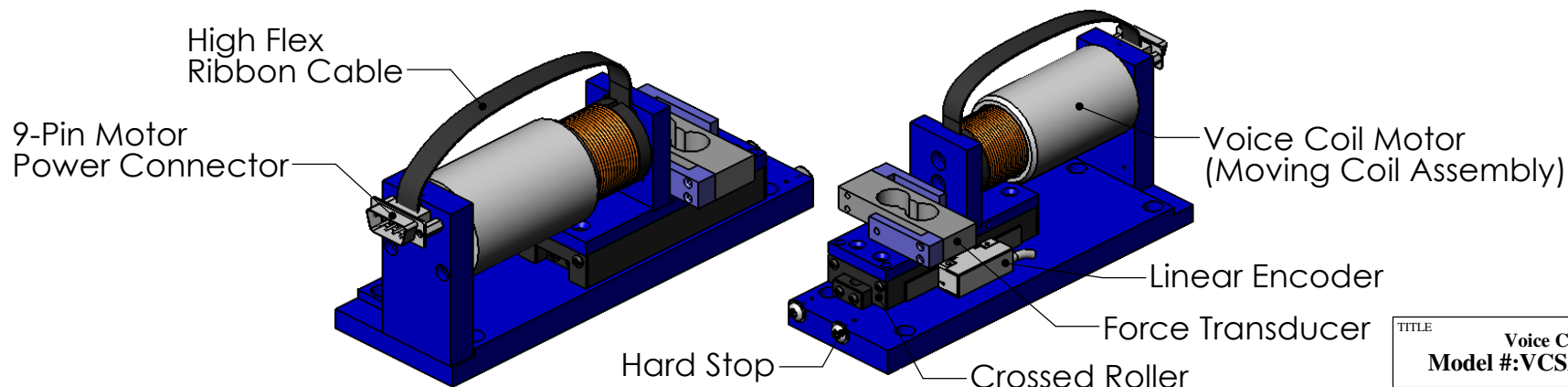

TITLE	Voice Coil Positioning Stage Model #:VCS20-020-CR-01-MC-F3K	
DWG #	31-0746	REV ---
		SHEET 2 of 2